

Memory Module Specifications

KSM29ES8/8MR

8GB 1Rx8 1G x 72-Bit PC4-2933

CL21 288-Pin DIMM

DESCRIPTION

Kingston's KSM29ES8/8MR is a 1G x 72-bit (8GB) DDR4-2933 CL21 SDRAM (Synchronous DRAM), 1Rx8, ECC, memory module, based on nine 1G x 8-bit FBGA components. The SPD is programmed to JEDEC standard latency DDR4-2933 timing of 21-21-21 at 1.2V. Each 288-pin DIMM uses gold contact fingers. The electrical and mechanical specifications are as follows:

FEATURES

- Power Supply: VDD = 1.2V Typical
- VDDQ = 1.2V Typical
- VPP = 2.5V Typical
- VDDSPD = 2.2V to 3.6V
- Nominal and dynamic on-die termination (ODT) for data, strobe, and mask signals
- Low-power auto self refresh (LPASR)
- Data bus inversion (DBI) for data bus
- On-die VREFDQ generation and calibration
- Single-rank
- On-board I2 serial presence-detect (SPD) EEPROM
- Temperature sensor with integrated SPD
- 16 internal banks; 4 groups of 4 banks each
- Fixed burst chop (BC) of 4 and burst length (BL) of 8 via the mode register set (MRS)
- Selectable BC4 or BL8 on-the-fly (OTF)
- Fly-by topology
- Terminated control command and address bus
- PCB: Height 1.23" (31.25mm)
- RoHS Compliant and Halogen-Free

SPECIFICATIONS

CL(IDD)	21 cycles
Row Cycle Time (tRCmin)	45.75ns(min.)
Refresh to Active/Refresh Command Time (tRFCmin)	350ns(min.)
Row Active Time (tRASmin)	32ns(min.)
Maximum Operating Power	*
UL Rating	94 V - 0
Operating Temperature	0° C to +85° C
Storage Temperature	-55° C to +100° C

*See IDD Specifications (page 2)

Module Assembly

DRAM: Micron (R-DIE)

Continued >>

IDD Specifications

Symbol	2933	Units
I _{DD0}	414	mA
I _{PP0}	36	mA
I _{DD1}	477	mA
I _{DD2N}	333	mA
I _{DD2NT}	351	mA
I _{DD2P}	270	mA
I _{DD2Q}	306	mA
I _{DD3N}	369	mA
I _{PP3N}	27	mA
I _{DD3P}	288	mA
I _{DD4R}	1017	mA
I _{DD4W}	882	mA
I _{DD5R}	414	mA
I _{PP5R}	45	mA
I _{DD6N}	288	mA
I _{DD6E}	468	mA
I _{DD6R}	171	mA
I _{DD6A}	72	mA
I _{DD6A}	171	mA
I _{DD6A}	261	mA
I _{DD6A}	468	mA
I _{PP6X}	45	mA
I _{DD7}	1350	mA
I _{PP7}	72	mA
I _{DD8}	216	mA

MODULE DIMENSIONS

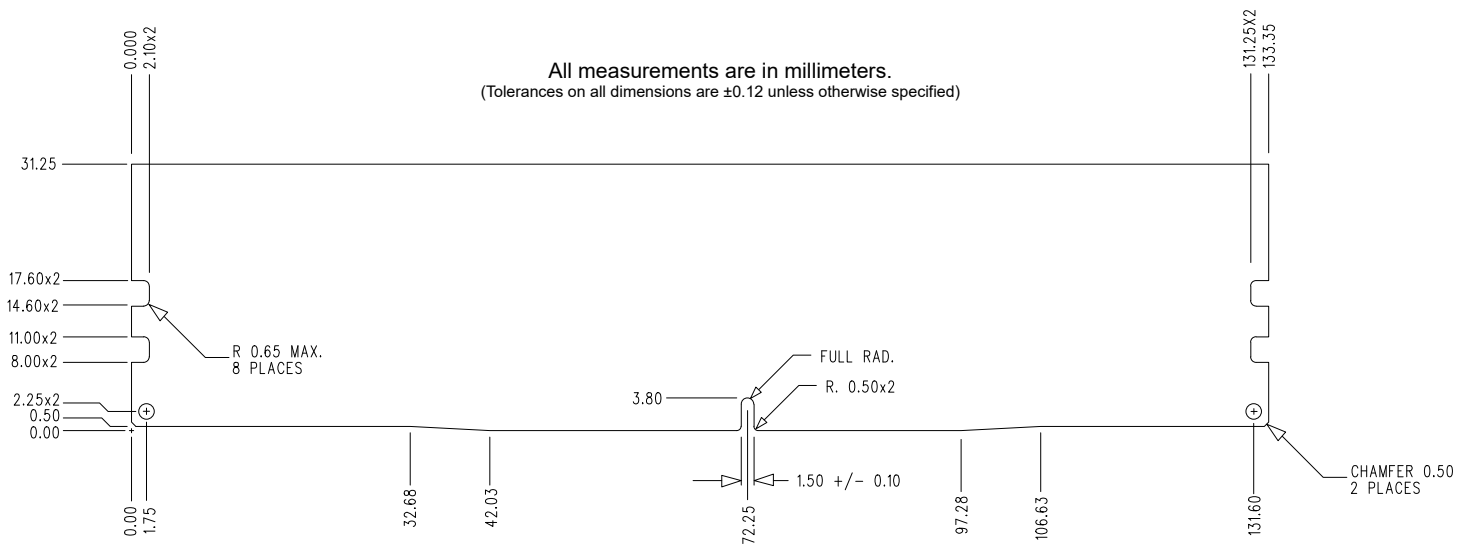
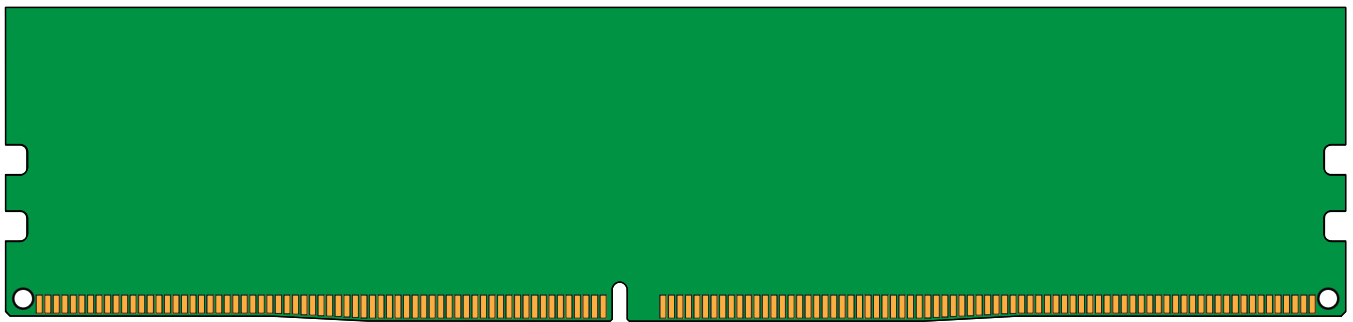
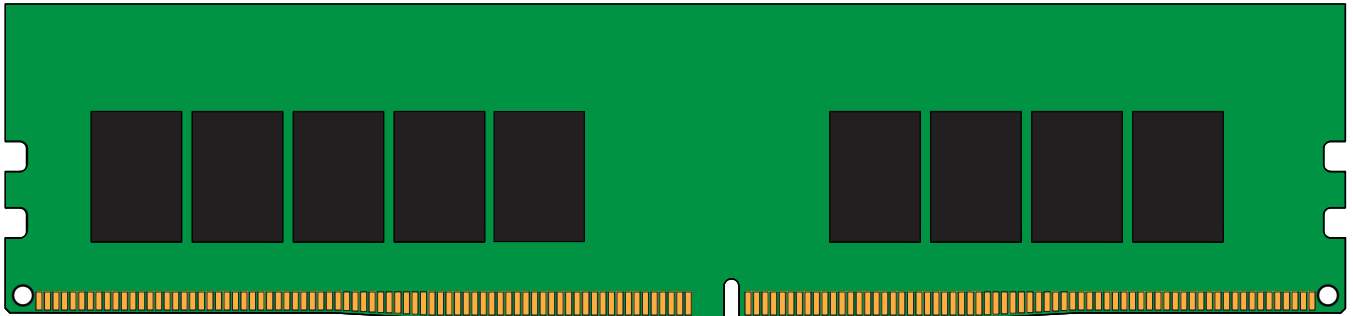

The product images shown are for illustration purposes only and may not be an exact representation of the product. Kingston reserves the right to change any information at anytime without notice.